



*One Solution  
for all Industries*

## JIG SERIES

**Intenal Gear Pump**



**SHIVAM ENTERPRISE**

Web : [www.jiksanpumps.com](http://www.jiksanpumps.com)

Email : [info@jiksanpumps.com](mailto:info@jiksanpumps.com)



# FUEL INJECTION INTERNAL GEAR PUMP



The INTERNAL GEAR pumps are based on the proven rotary trochoidal design - gerotor principle. The pumps are designed to meet specific demands of OEM's. The reliable performance of the JIG series makes them an ideal choice for various industrial applications.

## SPECIAL EXECUTIONS

- Specially coated internals for pumping of non-lubricating liquids.
- Engineering plastics rotor set for chemicals & low viscosity fluids
- Specially designed pumps for vacuum duty applications
- Uni-directional

## ADVANTAGES OF INTERNAL GEAR PUMPS

- Single shaft – well supported at both ends
- High suction lift and low noise level as well as vibrations
- High volumetric and overall efficiency
- Continuous, pulsation free flow due to axial entry in pumping element
- Compact and light – weight design
- Ease of assembling and dismantling without disturbing the pipeline.
- Choice of oil seal / Mechanical seal / gland pack.
- Parts / Pumps interchangeable with well known brands.

## TYPICAL APPLICATION

- Transfer from tank to tank
- Emptying of barrels
- Lubricating and cooling of bearings, gears, Mechanical seals and machine tools
- Fuel oil booster

## LIQUIDS HANDLED

- Fuel oil
- Lube Oil
- Neutral liquids with lubricating properties

## APPLICATIONS

- Filter pumping
- Pressure and transfer pump
- Pump for PHF units
- Pump for force feed lubrication
- Booster pump for diesel locomotive
- Oil burner
- Hydraulic drive and pressure pump – for gas oil, medium. Heavy and very heavy oil
- Transformers
- Boilers
- Vegetable oil processing
- Furnaces
- Suitable for LDO, FO, HSD & LSHS

PERFORMANCE TABLE (JIG series)

Model	INLET OUTLET SIZES	CAPACITY IN LPH	SPEED RPM	RECOMMENDED MOTOR HP		
				5 kg/Cm <sup>2</sup>	15 kg/Cm <sup>2</sup>	30 kg/Cm <sup>2</sup>
JIG-150	½" X ½" BSP	150	1440	0.25 HP	0.75 HP	1.5 HP
JIG-300		300		0.25 HP	0.75 HP	1.5 HP
JIG-450		450		0.50 HP	1 HP	2 HP
JIG-600		600		0.50 HP	1 HP	2 HP
JIG-1000	¾" X ¾" BSP	1000		0.75 HP	2 HP	3 HP
JIG-1500		1500		0.75 HP	2 HP	3 HP
JIG-2000		2000		1 HP	3 HP	5 HP
JIG-2500		2500		1 HP	3 HP	5 HP

## MATERIAL OF CONSTRUCTION

Pump Body : C.I. GR 25

Eccentric Cover : C.I. GR 25

Mechanical Seal Housing : MS

Shafted Rotor : EN-31 H & G

Idler Gear : EN-31 H & G

Wear Plate : PH-BRONZE

- Normal flow at 1440 or 2880 RPM with oil viscosity 32 CST at 37.5°C at normal working temperature and 10 kg/cm<sup>2</sup> pressure
- Higher or lower pressure on request.
- Direction of rotation as viewed from shaft end.
- L - anti clockwise
- R – clockwise

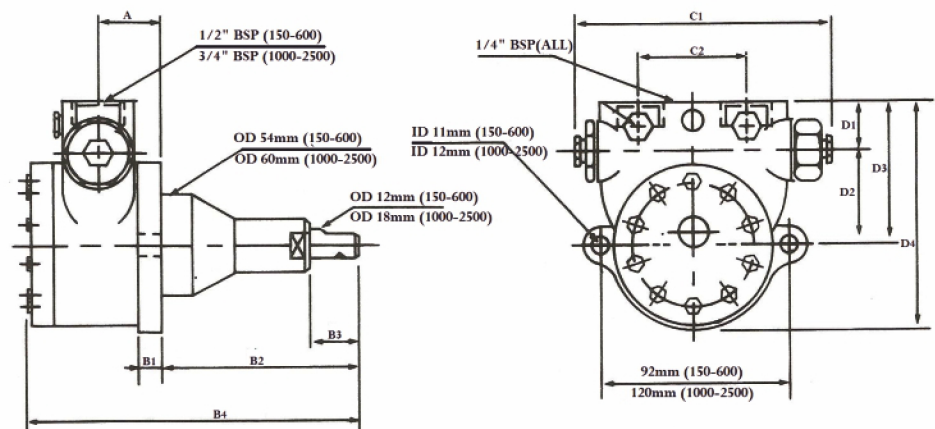

## DIMENSIONAL DRAWING DETAILS

Model	Flow in L/H		A	B1	B2	B3	B4	C1	C2	D1	D2	D3	D4
	1400 RPM	2880 RPM											
JIG	150-600	300-900	30	13	77	25	146	139	44	27	48	75	115
JIG	1000-2500	---	39	15	124	29	211	162	67	35	55	90	140

Note:- All dimensions are in millimeters. Unless otherwise stated specification are subject to change without prior notice as improvements are made from time to time.

**SHIVAM**  
**ENTERPRISE**

Mo : +91 95370 41188

16, Banker Estate, B/h. Bharat Party Plot, Rabari Colony,  
N.H.No. 8, Amraiwadi, Ahmedabad-380026.

Email : sales@jiksantpumps.com

Web : www.jiksantpumps.com

Distributor :