



*One Solution
for all Industries*

JRG SS SERIES

External Gear Pump



SHIVAM ENTERPRISE

Web : www.jiksanpumps.com

Email : info@jiksanpumps.com



ADVANCED TECHNOLOGY FOR PUMPING VISCOUS LIQUID



For Handling Of Corrosive, Hygienic, Abrasive Viscous Liquid To Transfer, Loading-Unloading & Pressuring Application.

Under "JIKSAN" brand name JRG-SS series external gear pumps are self priming bi-directional, positive displacement rotary pump in all stainless steel (SS-316) construction with dry lubrication PTFE coated DU bush bearing. These pumps are easy cleanable, easy maintainable in 3- piece construction. The back cover can simply be removed 4-dom nut. The right angle mounting brackets facilitates foot mounting of the pump on base plate with electric motor of appropriate ratings.

MATERIAL OF CONSTRUCTION :

• Pump Body : CF8M (S.S.316)	• Gears : AISI S.S.316	• Dom Nut / Ln Bolt : AISI S.S. 316
• Front Cover : CF8M (S.S.316)	• Shaft : AISI S.S.316	• Sealing : "Z" Pack Teflon
• Back Cover : CF8M (S.S.316)	• Bush Bearing : PTFE coated 'DU'	• Packing : Teflon Sheet
• Seal Cover : CF8M (S.S.316)	• Mounting Bracket : C.I. Gr.-20 IS 210	• Key For Coupling : AISI S.S. 316

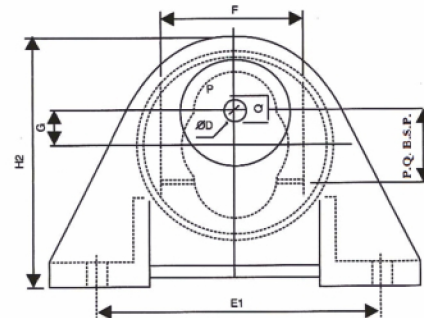
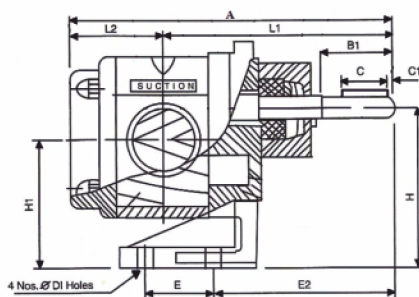

PERFORMANCE TABLE (JRG SS series)

PUMP MODEL JRG-SS	Suction & Delivery (Screw End)	CAPACITY at 1440 RPM			POWER REQ.			PUMP DIMENSION														WT. OF PUMP IN KG. APROX
								OVER ALL					MOUNTING & SHAFT									
		LPM	US GPM	M³/hr	NO LOAD VISCOUS HP. At		Unit HP. Per Kg. Press	A	F G	H2	L1	L2	E	E1	E2	H	H1	D D1	C C1	P Q	B1	
25	¼" X ¼"								54								11.5	17	4			
		8.33	2.2	0.50	0.20	0.25	0.02	129	12.5	101	94	35	40	120	82	63	50.5	8	3	13	25	2.50
40	⅜" X ⅜"	16.66	4.4	1.00	0.35	0.40	0.04	134	61	112	98	36	50	120	88	71	57	11.5	17	4	25	3.50
50	½" X ½"	25.00	6.6	1.50	0.40	0.50	0.06	146	14	112	103	41	50	120	88	71	57	8	3	13	25	4.50
75	¾" X ¾"	33.33	8.8	2.00	0.45	0.55	0.085	160	72.5	128	123	46	55	140	92	90	73	14	25	5	35	6.50
100	1" X 1"	50.00	13.2	3.00	0.50	0.60	0.13	177	17	128	115	52	55	140	92	90	73	10.5	3	16	35	7.50
125	1 ¼" X 1 ¼"	100	26.4	6.00	0.65	0.85	0.28	210	90	149	143	66	50	155	111	100	79	18	30	6	38	8.50
150	1 ½" X 1 ½"	125	33.0	7.50	0.75	0.95	0.35	225	21	149	151	73	50	155	111	100	79	12	3	20.5	38	11.90
200	2" X 2"	150	39.6	9.00	0.90	1.15	0.45	251	103	167	162	85	70	190	131	112	87	24	30	8	40	20.50
200		200	52.8	12.00	1.00	1.25	0.60	281	25	167	179	97	70	190	131	112	87	14	5	27	40	24.00
250	2 ½" X 2 ½"	250	65.0	15.00	1.20	1.40	0.65	299	122	197	206	93	85	200	161	132	102	28	40	8	50	35.00
250		300	80.0	18.00	1.40	1.65	0.77	319	30	197	218	101	85	200	161	132	102	16	5	32	50	40.00

Note:- All dimensions are in millimeters. Unless otherwise stated specification are subject to change without prior notice as improvements are made from time to time.

SPECIAL NOTE :

For calculating the power requirement at duty point, multiply the duty point pressure with unit horse power & add no load viscous power of appropriate viscosity. Provide safety margin before fixing the rating of the pri-mover. For high viscosity further marging may be kept or the manufacturer may be consulted. All sizes of JRG-SS pumps are designed to run at 1400 RPM up to viscosity of 500 CST, for small size pump up to 1" can be safely run at 1440 RPM even at higher viscosity up to 1000 CST with additional horse power. For sizes above 1" reduce the speed to 960 RPM for viscosity up to 1000 CST. For higher viscous liquid consult the manufacturer to avoid cavitation & over loading problem.

APPLICATIONS :

• This compact and efficient S.S. pump find various application for handling viscous food products like 1. Ghee 2. Butter 3. Fruit pulp 4. vegetable souse, kanji etc. • They are also used on pharmaceutical industries for handling 1. sugar solution, 2. glycerin, 3. glycol etc. • In chemical industries corrosive viscous chemicals can easy be handled with this pump most effectively.

**SHIVAM
ENTERPRISE**

Mo : +91 95370 41188

16, Banker Estate, B/h. Bharat Party Plot, Rabari Colony,
N.H.No. 8, Amraiwadi, Ahmedabad-380026.

Email : sales@jiksantpumps.com

Web : www.jiksantpumps.com

Distributor :